

THIS DRAWING IS AN UNCONTROLLED COPY UNLESS STAMPED OTHERWISE

CONTRACTORS SHALL VERIFY JOB DIMENSIONS BEFORE ANY JOB COMMENCES. ALL SHOP DRAWINGS SHALL BE SUBMITTED TO THE SUPERINTENDENT AND MANUFACTURER SHALL NOT COMMENCE PRIOR TO THE RETURN OF DIMENSIONS. SHOP DRAWINGS ISSUED BY THE CONSULTANT FIGURED DIMENSIONS SHALL TAKE PRECEDENCE OVER SCALED. THIS DRAWING SHOULD BE READ IN CONJUNCTION WITH ALL RELEVANT CONTRACT SPECIFICATIONS AND DRAWINGS COPYRIGHT OF THIS DRAWING IS VESTED IN HANDLE.

General Notes

REFER ARCHITECTURAL DRAWINGS:

- FACADE SETOUT AR1502-AR1507
- PRECAST SETOUT AR1512-AR1517
- SCREEN SETOUT AR1502-AR1557
- SCREEN DETAILS AR6550-AR6554

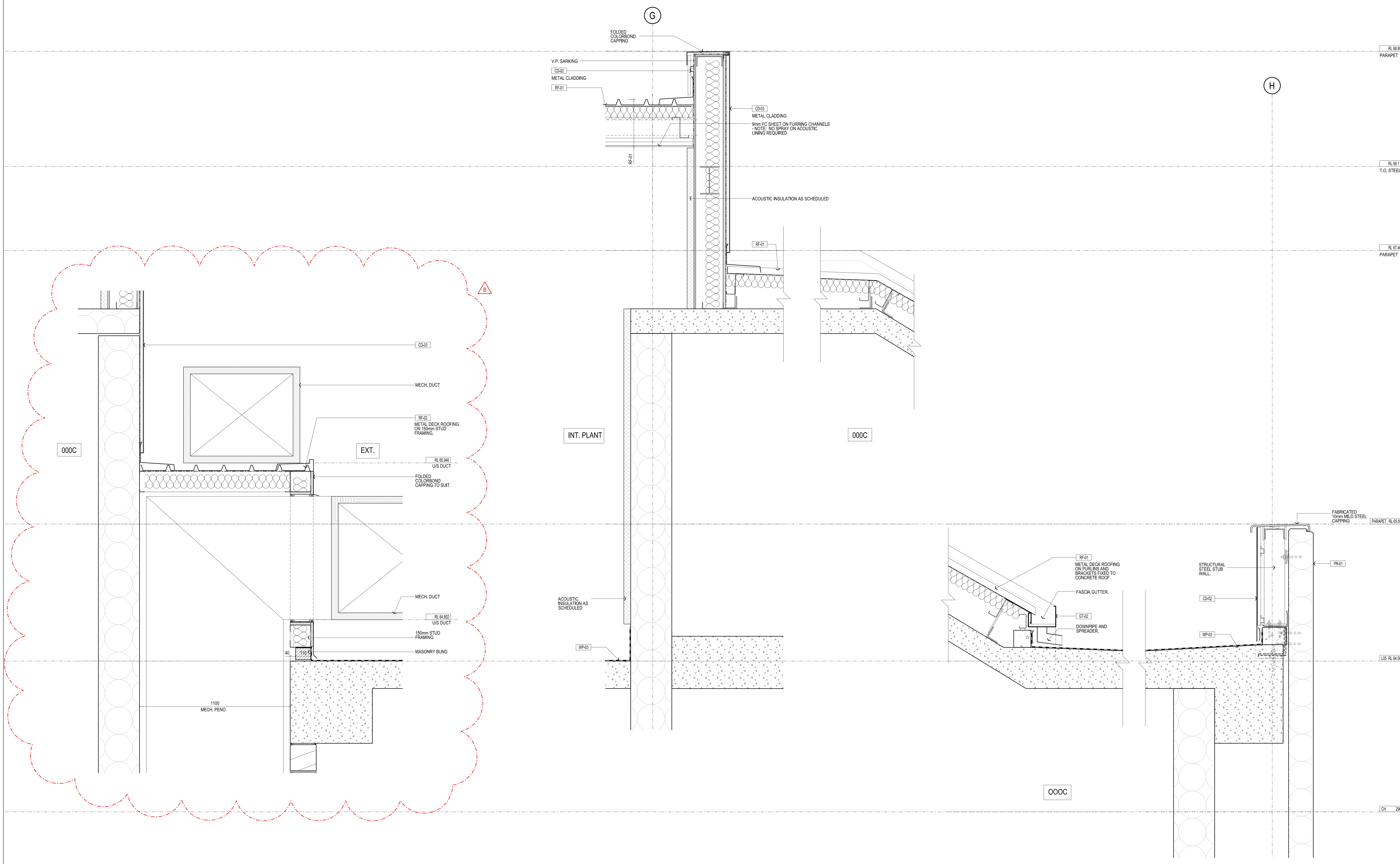

Rev	Issue	Revision Description	Amd	Date
B	SG	SECTION ADDED	-	13.01.14
		STEEL FRAMING REV. TO SUIT	-	22.10.13
A	SG	ISSUED FOR CONSTRUCTION	-	28.03.13
02	SG	VALUE MANAGEMENT ISSUE	-	28.03.13
01	SG	100% CD - TENDER ISSUE	-	07.09.12



**NADAAA**  
 NADAAA  
 1520 Washington Street No.2 Boston Massachusetts 02118 USA  
 Telephone +1 617 442 8232  
 Facsimile +1 688 442 1417  
 Email nadaa@nadaaa.com

**John Wardle Architects**  
 25 Rokeby Street, Collingwood, Victoria 3066 Australia  
 Tel : +61 3 8662 0400 www.johnwardlearchitects.com  
 © 2012 John Wardle Architects ABN 83 006 814 268

Client **University of Melbourne Parkville Campus**

Project **Faculty of Architecture Building and Planning**

Title **ROOF DETAILS ROOF SECTIONS - SHEET 5**

Project No.	<b>0913</b>	Scale	1:10 @ A0 1:20 @ A2
Drawing No.	<b>AR6204</b>	Revision	<b>B</b>

Date: Dec 2011 Drawn: Co-Ord: Check:

FILENAME - \$FILES

**FOR CONSTRUCTION**

00 SECTION DETAIL SCALE 1:10

01 SECTION DETAIL SCALE 1:10

02 SECTION DETAIL SCALE 1:10

03 SECTION DETAIL SCALE 1:10